

# Microframe Corporation

## Series 3007: DataPage Lite Transmitter



# Operating Manual

B3007-7012

\* B3007-7012 \*





# **SERIES 3007 DATAPAGE LITE TRANSMITTER**

## **INSTALLATION & SPECIFICATION GUIDE**

**ITEM NO: A3007-7012  
REVISION DATE: 07/02**

Microframe Corporation  
604 S. 12th Street  
Broken Arrow, OK 74012

Tel: (918) 258-4839  
Toll Free: 1-800-635-3811  
Website: [www.microframecorp.com](http://www.microframecorp.com)  
E-mail: [support@microframecorp.com](mailto:support@microframecorp.com)

## Merchandise Return

If your Unit does not work satisfactorily, please give us a call. We may be able to clear up the problem by phone. If it becomes necessary to return your Unit to the factory, please observe the following:

1. Place Unit in a sturdy box with sufficient packing material.
2. If requested, include the power supply.
3. Return the system insured and prepaid since we are not responsible for shipping damages and losses on returned Units.

## Warranty Service

For warranty service, please contact Microframe at 1-800-635-3811. A tech will gladly assist you.

## Assistance

For any product assistance or maintenance help, contact Microframe by either calling 1-800-635-3811 or emailing us at: [support@microframecorp.com](mailto:support@microframecorp.com).

## Safety

Do not install substitute parts or perform any modification to the product without first contacting Microframe.

## Warning

All power transformers, line cords, and electrical equipment should be kept out of the reach of children and away from water.

## Life Support Policy

**Microframe's products are not authorized for use as components in life support devices or systems without the express written approval of the president of Microframe Corporation.** As used herein:

1. Life support devices or systems are defined as systems which support or sustain life, and whose failure to perform when properly used in accordance with instructions for use provided in the labeling, can be reasonably expected to result in a significant injury to the user or anyone depending on the system.

2. A critical component is any component of a life support device or system whose failure to perform can be reasonably expected to cause the failure of the life support device or system, or to affect its safety or effectiveness.

## Disclaimer

We are constantly striving to improve our products. Due to this, specifications are subject to change without notice.

# TABLE OF CONTENTS

<b>DATAPAGE LITE SPECIFICATIONS .....</b>	<b>6</b>
<b>1 INSTALLATION PROCEDURES .....</b>	<b>7</b>
1.1 CONNECTING THE ANTENNA .....	7
1.2 CONNECTING POWER SUPPLY .....	7
1.3 PRECAUTIONS .....	7
<b>2 OPERATION .....</b>	<b>8</b>
2.1 SENDING A BASIC PAGE .....	8
2.2 SENDING A GROUP PAGE .....	8
2.3 PAGER TURN-OFF FROM BASE .....	8
2.4 TURNING OFF ALL PAGERS .....	8
<b>3 SYSTEM OVERVIEW .....</b>	<b>9</b>
3.1 DESCRIPTION .....	9
3.2 RANGE EXPANSION .....	9
3.3 IMPORTANT INFORMATION .....	9
3.4 SAFETY INFORMATION .....	9
3.5 CARE OF TRANSMITTER .....	9
3.6 LIABILITY .....	9
3.7 WARRANTY INVALIDATION .....	9
3.8 SERVICE INFORMATION .....	9
<b>5 GEO PULSAR USER GUIDE .....</b>	<b>10</b>
5.1 TURNING ON THE PAGER .....	10
5.2 SENDING A PAGE .....	10
5.3 SENDING AN ALPHA MESSAGE .....	10
5.4 SENDING A NUMERIC MESSAGE .....	10
5.5 RECEIVING A PAGE .....	10
5.6 SENDING A GROUP CALL PAGE .....	10
5.7 MANUAL PAGER TURN-OFF .....	10
5.8 PAGER TURN-OFF FROM BASE .....	10
5.9 POWER CHECKING .....	10
5.10 LIGHTING FUNCTION .....	10
5.11 CAUTION .....	10
<b>MINI DIPOLE ANTENNA MOUNTING .....</b>	<b>11</b>



# DATAPAGE LITE SPECIFICATIONS

## On-Premise Paging

### Features

The DataPage Lite Transmitter can send a 12-digit numeric message code to any of 9,999 different pagers. Since you own the transmitter(s) and receivers, you can enjoy unlimited paging with no monthly service fee. Available for desk mount only.

### Operation

The DataPage Lite is a simple plug and play system. Once the transmitter is plugged in and batteries are inserted into the pagers, the system is ready. A page is transmitted when the pager number or group number is entered using the number keys on the base. Pagers may be turned off from the base or individually.



DataPage Lite Transmitter



DataPage Lite Transmitter



Scope GEO Pulsar  
Numeric Pager

### DataPage Lite Specifications

Frequency Range .....	457.575 MHz or 457.550 MHz
TX Baud Rate .....	1200
Distance Range .....	1/4 to 1/2 Mile
FCC Approval No. ....	JRNUSASERILINK
Mounting .....	Desk Mounted

**Support and Sales**  
**800-635-3811**

**Microframe® Corporation**  
**www.microframecorp.com**

**P.O. Box 1700**  
**Broken Arrow, OK 74013**

# 1 INSTALLATION PROCEDURES

## 1.1 CONNECTING THE ANTENNA

Connect the 90 degree antenna to the BNC connector located at the side of the transmitter. Slide the plastic cover over the connector, engaging the two lugs into the corresponding recesses in the side of the case. This will maintain the antenna in an upright position, which is important for optimizing the range of the transmitter (See Figure 1).

The flashing cursor invites you to enter a pager number (this can be any number between 1 and 9,999) after which you must press SEND to transmit a page. See "Operation" for further transmitting procedures.

**IMPORTANT NOTE:**  
**Use only the power supply included with your system! The use of non-approved power supplies will invalidate all warranty and service. We also recommend using a surge suppressor for protection. Power surges are not covered under the warranty.**

## 1.2 CONNECTING POWER SUPPLY

Connect the AC adapter power lead to the power socket located at the far right-hand rear corner of the base station (See Figure 2).

Plug the power supply into a convenient wall socket and turn on the power. When the unit is first powered up, the system will display the following screen for a few seconds:

**DATAPAGE  
LITE**

Followed by:

**PAGER: (1-9999)  
>**

## 1.3 PRECAUTIONS

Avoid mounting the transmitter in the immediate vicinity of telephones, exchanges or computer equipment. A few feet can make a world of difference in avoiding interference from the radio frequency generated by the transmitter.

The performance of your system will be affected by: foil backed wallboard, metal mesh, wire-reinforced glass, metal sheeting, large mirrors, suspended ceilings, elevator shafts, etc. These can all reflect and thereby reduce the signaling capability of the transmitter. A little forethought prior to installation, coupled with a few tests, will avoid most problems.

**Figure 1: Connecting the Antenna and Locking Cover**

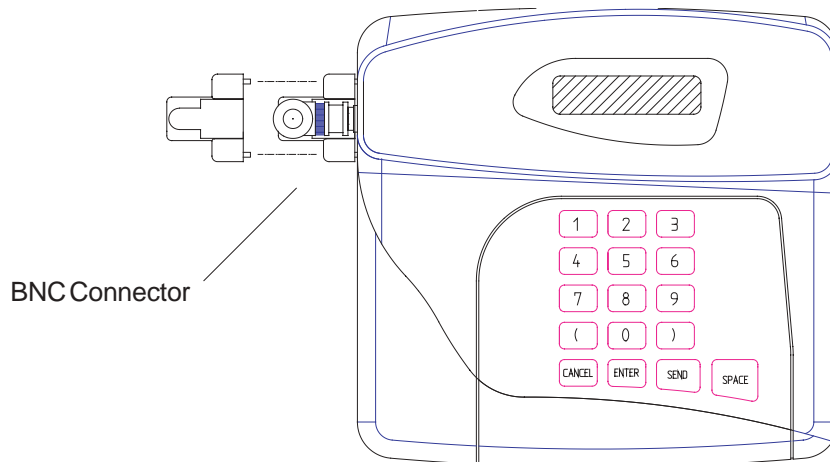

## 2 OPERATION

### 2.1 SENDING A BASIC PAGE

In the most basic use of the transmitter, simply type the pager number and then press "SEND." This will cause the pager with the corresponding number to vibrate.

### 2.2 SENDING A GROUP PAGE

The pagers are capable of receiving both individual pages or a group page. To send a group page, simply type the group call number instead of the pager number in any of the paging steps above. By default, the group call number is "900," unless otherwise specified by the customer.

### 2.3 PAGER TURN-OFF FROM BASE

Enter the pager number followed by the "ENTER" key. Press "ENTER" again to bypass "Beep Type" screen. When screen reads "Enter Message," type the code "**((123456**" followed by "SEND." **NOTE: The two left parenthesis before the number are required, or it will not work.**

### 2.4 TURNING OFF ALL PAGERS

To simultaneously turn all pagers off at the base, type in the group call number "900" followed by "ENTER." Press "ENTER" again to bypass "Beep Type" screen. When screen reads "Enter Message," type the code "**((123456**" followed by "SEND."

\* Please see instructions in the back of this manual for particular pager use.

## 3 SYSTEM OVERVIEW

### 3.1 DESCRIPTION

The Datapage Lite is a desktop transmitter that can be used to transmit numeric messages to individual pagers or even an entire group of pagers. The system can accommodate up to 9,999 pagers. The transmitter base identity can be configured to prevent interference with other systems. This transmitter can also transmit an out-of-range signal. This allows pagers to indicate when they are no longer within signal range.

### 3.2 RANGE EXPANSION

The range and performance of this equipment can be improved by the addition of more efficient antennas.\* These can be installed either inside or outside the building and are connected to the transmitter with 50 OHM coaxial cable.

The center-fed half wave dipole, measuring approximately 12 inches from tip to tip, will provide excellent all round local signalling. It is a light duty antenna suitable for sheltered environments/internal installation (LUHFDP). It includes a 15 foot cable.

NOTE: High frequencies can equate to high power losses. Always use quality cable. RG58 is only acceptable on cable runs of up to 5 meters (16.4 feet.) We recommend RG213, or equivalent, on greater lengths. If in doubt consult your dealer.

*\*Subject to license conditions. Specifically, mounting height and Effective Radiated Power (ERP).*

### 3.3 IMPORTANT INFORMATION

It is the purchaser's responsibility to determine the suitability of this equipment and its derivatives for any given application.

Good working practice dictates that a suitable system installation log must be generated, together with a record of the dates when the system has been manually checked, (with the aid of signal strength meters, etc.) enabling the system performance to be compared with the original installation data.

### 3.4 SAFETY INFORMATION

These products are designed to operate safely when installed and used according to general safety practices. The following requirements should be observed at all times:

Do NOT subject this equipment to:

- Mechanical shock
- Excessive humidity or moisture
- Extremes of temperature
- Corrosive liquids

This equipment is designed for indoor use, unless expressly stated otherwise, and must not be used in classified Hazardous Areas, including areas containing explosive or flammable vapors, unless express authorization has been given in writing by the manufacturer. If in doubt, consult your local product dealer for further information.

Do not obstruct any slots or openings in the product. These are provided for ventilation to ensure reliable operation of the product and to protect it from overheating.

### 3.5 CARE OF TRANSMITTER

Only use a damp cloth for cleaning (not liquid or aerosol-based cleaners), and ensure that any power is removed from the unit prior to beginning the cleaning operation.

Removal of covers from the equipment must only be undertaken by authorized service personnel, who must ensure that power is isolated prior to removal.

### 3.6 LIABILITY

Scope and Microframe do not accept liability for any damage or injury, caused as the result of misuse of this equipment. It is the responsibility of the user to ensure that the equipment is operated in the manner for which it was intended, and that it is the correct item of equipment for the required task.

### 3.7 WARRANTY INVALIDATION

Alteration or modification to any part of this equipment, without the prior written consent of the manufacturer, will invalidate all manufacturer approvals and warranties. No adjustments can be undertaken except by qualified and licensed persons as defined by the FCC Rules and Regulations. Operation of altered equipment can result in fines, imprisonment, and/or confiscation of such equipment.

### 3.8 SERVICE INFORMATION

If you experience a problem with your equipment, please contact Microframe at 1-800-635-3811.

## 5 GEO PULSAR USER GUIDE

### 5.1 TURNING ON THE PAGER

Hold down the "LARGE BLACK BUTTON" until the pager comes on.

### 5.2 SENDING A PAGE

When the transmitter is turned on, the prompt "PAGER (1-9999)" appears on the screen. To send a page, enter the pager number on the transmitter's number pad followed by the "SEND" key.

### 5.3 SENDING AN ALPHA MESSAGE

To send a pre-defined message to a pager, enter the pager number followed by the "ENTER" key. You will be prompted for a "BEEP TYPE (1-4)." Select 1-3 here and press the "SEND" key. If no number is chosen, the pager will default to Beep Type 4 ("PAGING").

### 5.4 SENDING A NUMERIC MESSAGE

To send a numeric message to a pager, simply enter the pager number followed by the "ENTER" key. The transmitter screen will display "BEEP TYPE." Simply press "ENTER" to bypass this. The transmitter screen will then display "ENTER MESSAGE." Using the number keys, enter up to a 16-digit numeric message followed by the "SEND" key. *Note: Since a numeric message is entered after the "BEEP TYPE," (pre-defined message) prompt, the alpha message selected will be ignored.*

### 5.5 RECEIVING A PAGE

The GEO Pulsar will start to vibrate when it is paged. No action is necessary on the receiving end at this point. The pager will stop vibrating after approximately 8 seconds. If the user would like to stop the vibration before the 8 seconds, simply press the "LARGE BLACK BUTTON." If a numeric message is sent to the pager, the message will be visible on the pager screen until the pager stops vibrating. To view the message after the pager has stopped vibrating, press the "LARGE BLACK BUTTON" once.

### 5.6 SENDING A GROUP CALL PAGE

All pagers respond to call number "900" (unless another group call number has been chosen). To page all pagers at once, simply enter "900" and "SEND."

### 5.7 MANUAL PAGER TURN-OFF

Press the "RIGHT ARROW BUTTON." The words "PGR OFF" will appear on the LCD screen. Press the "LARGE BLACK BUTTON" once to confirm. *NOTE: If you have chosen to disable the pagers' on/off button, the pagers can only be turned off from the transmitter.*

### 5.8 PAGER TURN-OFF FROM BASE

Enter the pager number followed by the "ENTER" key. Press "ENTER" again to bypass "BEEP TYPE" screen. When screen reads "ENTER MESSAGE," enter the message code "((123456" followed by "SEND." **NOTE: The two left parenthesis before the number are required, or it will not work. This "(" symbol is located to the left of the "0" key and beneath the "7" key.**

*Since all pagers respond to call number "900," paging "900" with the message code "((123456" will turn all pagers off.*

### 5.9 POWER CHECKING

When the battery level is low, a low-battery symbol will appear at the bottom of the pager screen.

### 5.10 LIGHTING FUNCTION

Pressing the "LEFT ARROW BUTTON" for one second can turn on the backlight on the LCD screen. The light will shut off automatically after approximately 10 seconds, or the user may turn the light off manually by pressing the "LEFT ARROW BUTTON" once.

### 5.11 CAUTION

- a) The pager is made up of LCD and precision elements. Avoid water and high temperature.
- b) Remove the battery if the pager will not be in use for a long period of time.
- c) If the pager is not working properly, do not dismantle or repair it yourself.

# MINI DIPOLE ANTENNA MOUNTING

## Optional Range Extender

For optimum operation, the dipole radiators must be positioned **vertically**, with the "E" symbol facing downwards towards the ground.

Avoid mounting the dipole on or near to any metal girders, pilars or other metallic obstructions.

The dipole should preferably be mounted at a height which avoids potential snagging with any moveable objects that might be used in the vicinity e.g. ladders.

Ensure that the bracket is firmly bolted to a solid surface and that the feeder cable is adequately clamped along its entire run between the dipole and the transmitter/receiver.

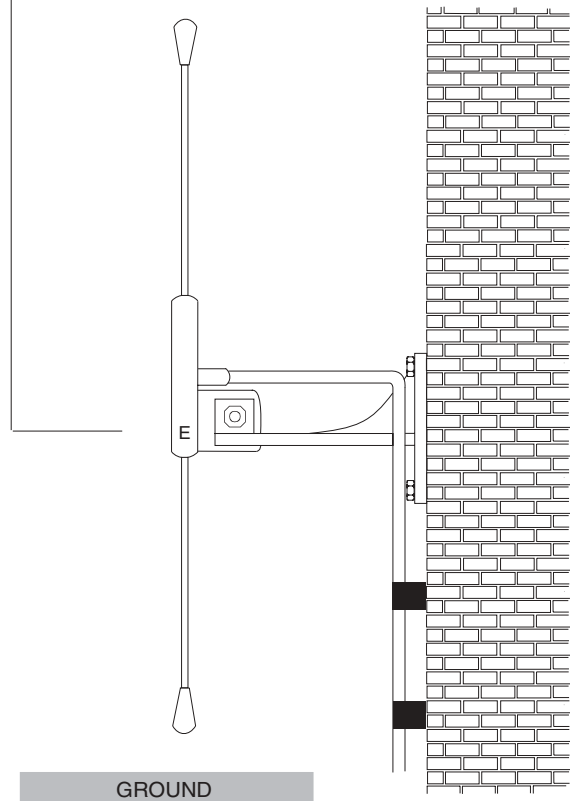

B3100/AX/9700